

1800/1900 SERIES

Manual Part #: 201002

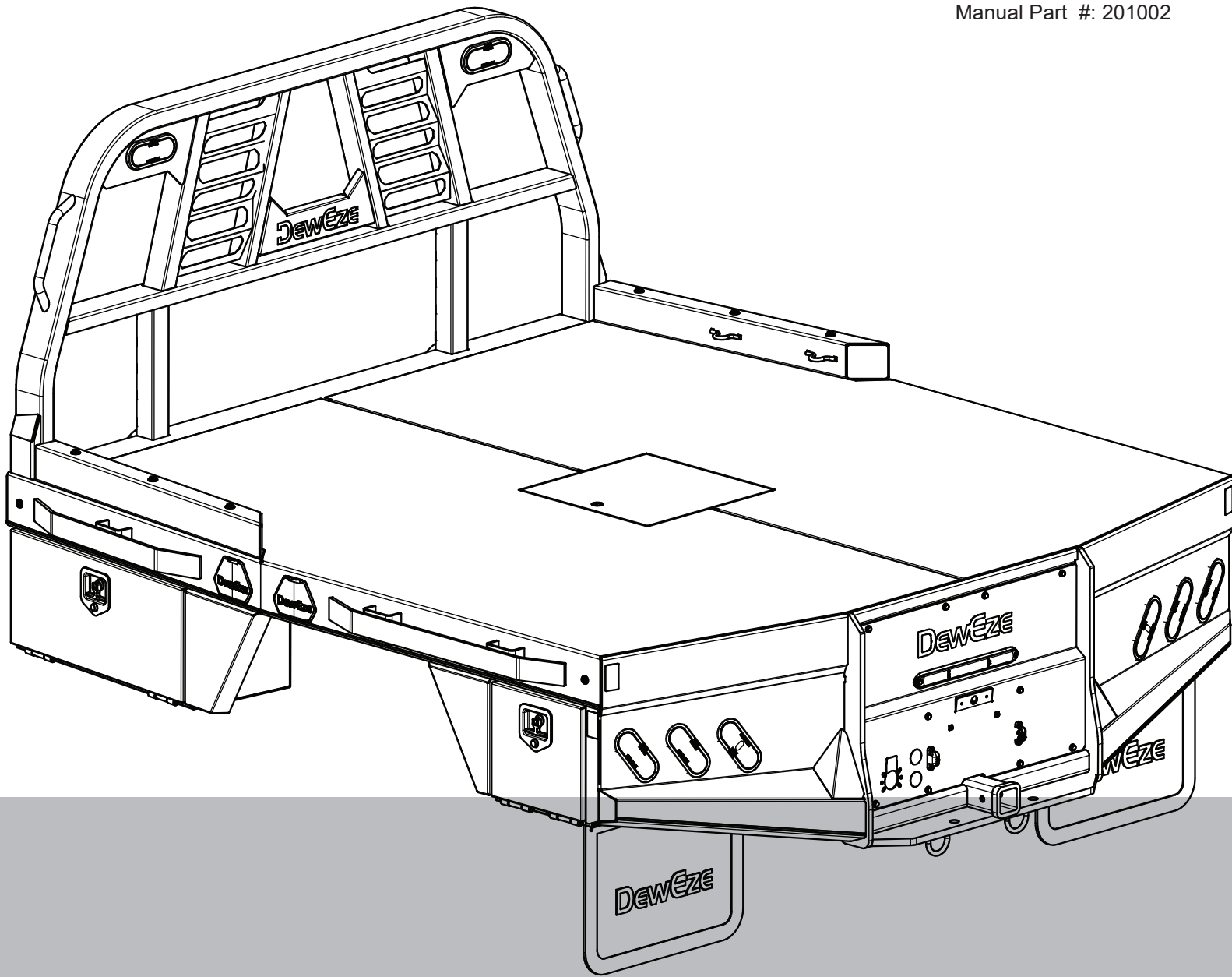

DewEze®

Thank you for purchasing a DewEze Flatbed.

TO THE OWNER OR OPERATOR:

As with all Harper products, the 1800 and 1900 Series Flatbeds have been thoroughly tested and built to provide a sturdy, dependable product. This manual is written as an aid to operating and maintaining the DewEze Flatbed. Read and understand the manual thoroughly before operation to avoid damage to the unit or injury to the operator or bystanders.

A Flatbed can present hazards to an operator who follows unsafe procedures in either the operation or maintenance of the unit. Therefore, **SAFETY WARNINGS** are present at certain locations in the text. Harper Industries is not responsible for accidents or injuries that result from the misuse or lack of maintenance of the Flatbed.

SYMBOL:



MEANING: Failure to understand and obey this warning may result in injury to you or others. Whenever this symbol is used, please pay very close attention to the information presented, and make sure you fully understand. If you do not, contact your dealer or Harper Industries for clarification.

///HARPER INDUSTRIES, INC.

151 E. HWY. 160 Harper, KS 67058
(620) 896-7381 • **Fax** (620) 896-7129

Toll Free 800-835-1042

Email info@deweze.com

Website www.deweze.com

© 2025 Harper Industries, Inc.

The Harper and DewEze names and the logo are registered trademarks of Harper Industries, Inc. All other brand and product names are trademarks or registered trademarks of their respective companies.

Statement of Warranty

Harper Industries, Inc. (HII) warrants to each purchaser of a new DewEze Flatbed from an authorized dealer or representative, that such equipment is free of manufacturer's defects in workmanship and materials which appear while in normal service for a period of TWO YEARS commencing with delivery to the original user. The Flatbed electrical systems are warranted for a period of ONE YEAR.

The obligation of HII under this warranty is expressly limited, at our option, to replacement or repair at a service facility designated by Harper Industries or at the manufacturing plant in Harper, KS. A part will be replaced after inspection discloses it to have been defective. This warranty does not apply to defects caused by damage or unreasonable use (including failure to provide reasonable and necessary maintenance, or by performing functions without genuine DewEze Flatbed accessories) while in the possession of the consumer.

Warranty is limited to parts, labor and ground freight delivery of replacement parts. Labor for repair electrical power systems from HII installed with bed purchase/installation is covered under this warranty. HII shall not be liable for the consequential damages of any kind, including but not limited to consequential labor costs or transportation charges in connection with replacement or repair of defective parts.

This warranty does not apply to parts subjected to misuse, abuse, alteration, improper or inadequate maintenance, or normal wear.

Harper Industries makes no warranty with respect to trade accessories. They are subject to the warranties of their respective manufacturers.

ANY IMPLIED OR STATUTORY WARRANTIES, INCLUDING ANY WARRANTY OR MERCHANTABILITY OR FITNESS FOR A PARTICULAR PURPOSE, ARE EXPRESSLY LIMITED TO THE DURATION OF THIS WRITTEN WARRANTY. HII makes no other express warranty, nor is anyone authorized to make any on behalf of HII.

For further information please contact your nearest DewEze Flatbed dealer.

RECORDS

Date of Purchase _____ / _____ / _____

Dealer's Name _____

Dealer's Phone _____

Serial Number Bed _____

Serial Number Pump _____

Table of Contents

OPERATOR SECTION

To the Owner or Operator.....	1
Warranty Statement.....	2
Table of Contents.....	3

Specifications

Bed Model Chart.....	4
Toolboxes, Skirts.....	4
Feature Identification.....	5
Safety Guidelines	
General Equipment Safety.....	6
Flatbed Operation Safety.....	6
Decal Identification.....	6
Appendix I	
GatorHyde Repair.....	7

Parts

Dummy Arms.....	9
Electrical Routing.....	10
Electrical Harnesses.....	11
OEM to Flatbed Adapter Harnesses.....	12-13
Bed Lights.....	14
Headache Rack Lights & Work Lights.....	15
Headache Rack Plate.....	16
Ball Well and Receiver Hitch Adapter.....	17
Skirts.....	18-19
Toolboxes & Toolbox Install Kits.....	20-21
Mudflaps.....	21
Rear Camera Mounts.....	22
Bed Mounting Kits.....	23

Specifications

MODEL SPECS

BED MODEL	1870	1871	1876	1879	1976	1984	1988
REAR WHEELS	Single	Single	Single	Single	Dual	Dual	Dual
DIMENSIONS	7'1" x 7'2"	7'1" x 7'7"	7'1" x 8'11"	7'1" x 9'10"	8' x 8'11"	8' x 9'10"	8' x 11'10"
CAB-TO-AXLE	37"	40-42"	56-58"	60"	56-58"	60"	84"
TRUCK BRAND	Ram	GM/Ford	All	Ford/Ram	All	All	All
SETUP CODE	Box Removal	Box Removal	Box Removal	Cab/Chassis	Box Removal	Cab/Chassis	Cab/Chassis

*Length of all flatbeds includes 6" for crosstube

Bed Model	Single	Dual	Box Remove	Cab-Chasis	Truck Frame Length	Notes
1870	X		X		6'10"	Ram
1871	X		X		7'3"	Ford/GM
1876	X		X		8'7"	Ford/Ram/GM
1879	X			X	9'4"	Ford/Ram
1976		X	X		8'7"	Ford/Ram/GM
1984		X		X	9'4"	Ford/Ram/GM
1988		X		X	11'6"	Ford/Ram/GM

TOOLBOX SELECTION CHART

Details on pg. 20

BED MODELS	FRONT TOOLBOX	REAR TOOLBOX	
	ALL BEDS	BEVELLED	SQUARE
1870	14.5"	14.5"	18"
1871	18"	14.5"	18"
1876	30"	14.5"	18"
1879	30"	18"	24"
1976	30"	14.5"	18"
1984	30"	18"	24"
1988	30"	18"	24"

TOOLBOX P/N'S

TOOLBOX	PART #
14.5"	263003
18"	263004
24"	263002
30"	263001

*Front toolbox dimensions are the same across all pivot & parallel beds.

SKIRT KIT P/N SELECTION CHART

Details on pg. 18

BED MODELS	FRONT (w/TBX)	REAR (w/TBX)		REAR (no/TBX)	
	ALL BEDS	BEVELLED	SQUARE	BEVELLED	SQUARE
1870	264049	264049	264062	264047	264053
1871	264049	264049	264062	264047	264053
1876	264062	264049	264062	264047	264053
1879	264062	264062	264062	264053	264054
1976	264062	264049	264062	264047	264053
1984	264062	264062	264062	264053	264054
1988	264088	264062	264062	264053	264054
1988x2 30" TBX	264049	264062	264062	264053	264054

Specifications

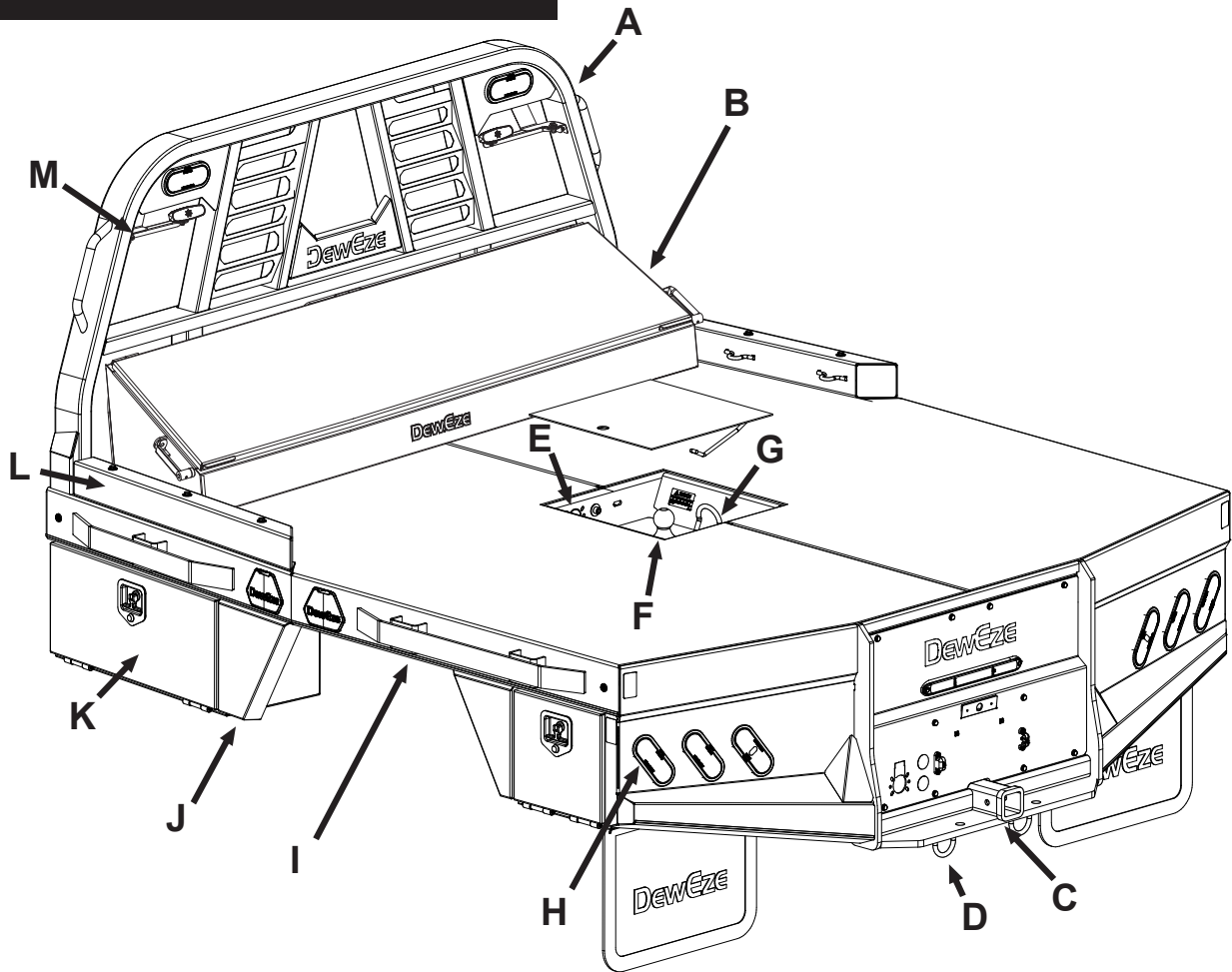

A. Headache Rack - Protects the rear pickup window.

B. Across-the-Bed Toolbox (optional) - Has a shelf mounted inside. Toolbox is 78" wide, 15.5" tall and 21.5" deep.

C. Hitch Plate - 2.5" with a 2" adapter. Has holes for hitch pins.

D. Safety Chain Loops - Always use safety chains when towing.

E. Trailer Plug Knockout - Available space to install trailer plug in the ball well.

F. Gooseneck Hitch - Located under a cover plate in the middle of the bed.

G. Safety Chain Loops - Always use safety chains when towing.

H. Lights - LED lighting for stop-tail-turn has long life and low current draw.

I. Rub Rails (optional) - Protect your straps.

J & K. Skirts & Toolboxes (optional) - Mount under front and/or rear of bed on both sides.

L. Dummy Arms - Serve as side rail

M. Swing Lights (optional) - Lights can be pivoted.

Safety

Operator safety is of utmost concern when designing and developing a new piece of equipment. Designers and manufacturers build in as many safety features as possible. Many accidents occur which could have been avoided by a few seconds of thought and a more careful approach to handling equipment. Most accidents can be avoided by observing the precautions in this section. To avoid personal injury, study the safety warnings and cautions listed in this manual and follow them.

General Equipment Safety

- Do not allow persons to operate or assemble this unit until they have read this manual and have developed a thorough understanding of the safety precautions and how the unit works.

- Do not attempt to operate equipment under the influence of drugs or alcohol.
- Review the safety warnings and cautions with all users annually. If you have any questions not answered in this manual or require additional copies, contact your dealer or Harper Industries.

Flatbed Operation Safety

- Ensure all safety pins are in place and flatbed mounting bolts are secure to the truck frame.
- Check with truck dealer for any load limits, additional suspension or tire requirements. The flatbed's lifting capability may exceed the truck's load capacity in some instances.
- Replace any CAUTION, WARNING, DANGER or instruction decal that is illegible or missing. Decals are available from your DeweZe dealer.

1800/1900 Decals

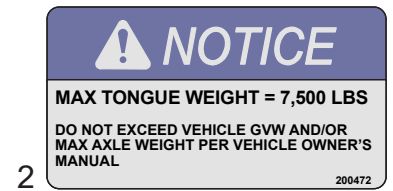
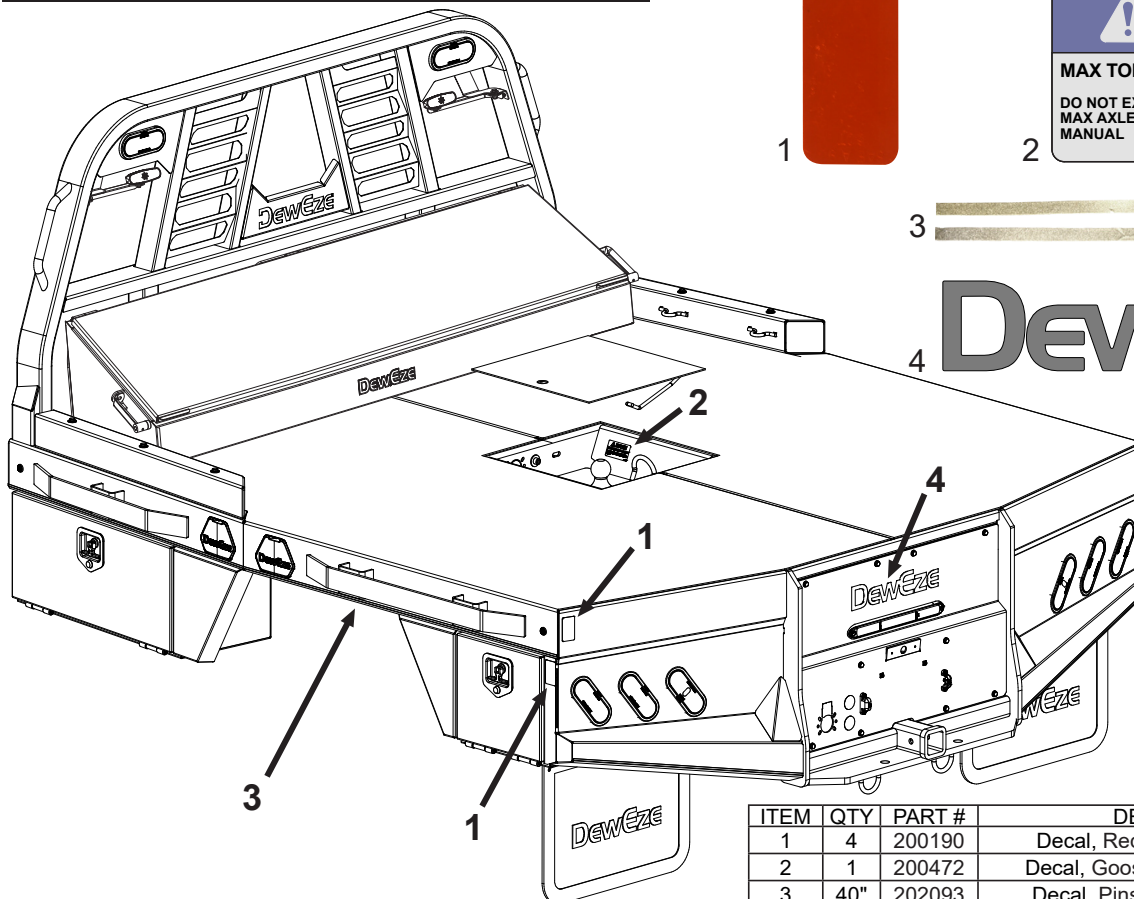

ITEM	QTY	PART #	DESCRIPTION
1	4	200190	Decal, Red Reflector Rectangle
2	1	200472	Decal, Gooseneck Tongue Weight
3	40"	202093	Decal, Pinstripe -40 Warm Silver
4	1	202175	Decal, "DeweZe" Tailboard (No Grfx)

GatorHyde Repair Instructions

Required items:

- 1 – 25 x 25 ml caulking gun (202030)
- 1 – 25 x 25 ml cartridge set of GatorHyde Repair Material (202031)
- 1 – ¼" x 6" mixing wand (202032)
- 1 – pair of rubber gloves
- 1 – wooden stick
- 1 – Instruction sheet and MSDS sheet
- 1 – MEK – methyl ethyl ketone solvent (available at most hardware stores)
- 1 – small paint brush
- 2 – plastic cups



SAFETY WARNING!

Read the Master Safety Data Sheets (MSDS) on all chemicals before handling any chemical.

See: <http://www.msds.com>

Note:

This repair is designed to easily fix small, damaged areas fast and with limited amount of effort. However this product is fast reacting so make sure to thoroughly read this instruction sheet before proceeding with repairs.

Application Instruction:

- Step 1.** Before you start, put on rubber gloves and safety glasses.
- Step 2.** Place a piece of cardboard or newspaper next to the repair area prior to opening and mixing the material.
- Step 3.** Cut back damaged area with a razor knife to make a square.
- Step 4.** Sand area and feather edges with 40 grit sandpaper. Blow out sanded area to get rid of dust.
- Step 5.** Clean area well with MEK solvent and allow to dry for 30 minutes.
- Step 6.** Attach static mixing wand to 25 x 25 ml cartridge set, twist and lock in place. Insert cartridge into caulking gun.
- Step 7.** Hold the caulking gun in an upright position in one hand, then set the two plastic cups on a flat surface side by side. Next point the static mixing wand into a cup and squeeze the trigger of the gun two times so a small amount of material is discharged into the cup. (Note! This material is to be discarded.) Immediately move the static mixing wand over and point it into the next cup and continue to discharge the remaining amount of material into this cup.
- Step 8.** Allow the material to set in cup and gently stir with wooden stick for a period of 1 to 1 ½ minutes or until the GatorHyde becomes thicker and will stick to either a finger or wooden stick.
- Step 9.** Once material has begun to gel, apply enough product to finger or a stick and immediately dab onto damaged area. Use the paint brush to dab the area in a vertical manner to make a textured surface.
- Cure time.** Allow repaired area to cure for a period of 1 hour prior to heavy impact loading.
- Clean-up.** In order to clean up the area take a paper sack or plastic trash bag and place all the empty jars and remaining contents of the repair kit and dispose into a standard trash can or simply put everything back in the box and throw away.

GatorHyde Protective Coatings, Inc., 2210 South Highway 69, Wagoner, OK 74467 * (918) 485-2835 *
www.gatorhyde.com

DewEze®

1800/1900 SERIES

PARTS

DUMMY ARMS

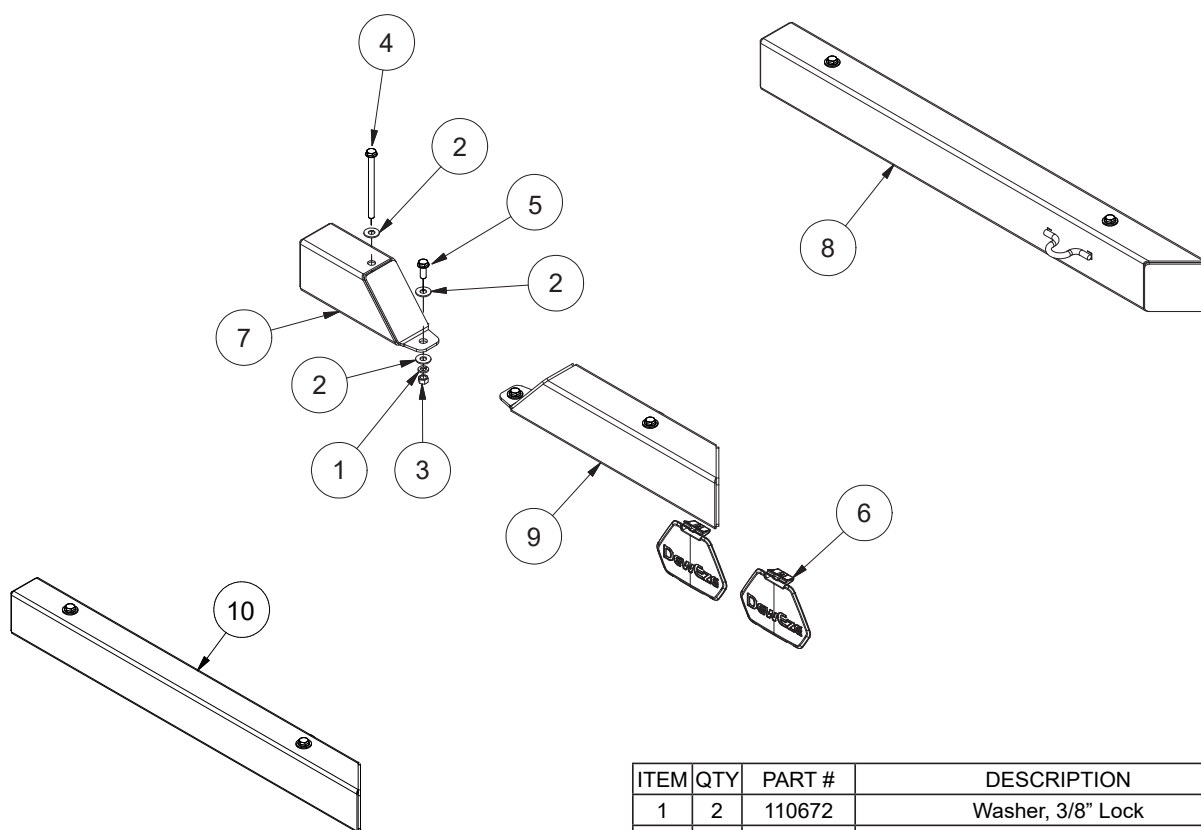

ITEM	QTY	PART #	DESCRIPTION
1	2	110672	Washer, 3/8" Lock
2	8	110676	Washer, 3/8" Flat Standard
3	2	110826	Nut, 3/8-16 GR 5
4	4	111268	Bolt, 3/8-16 x 5, Wiz Flange Gr. 5 Zinc
5	2	110440	Bolt, 3/8-16 x 1, Wiz Flange Gr. 5 Zinc
6	2	202168	Cover, Fuel & Def
7	1	See Chart	Dummy Arm, FRONT, Cake Feeder
8	1	See Chart	Dummy Arm, PASS. Side
9	1	See Chart	Dummy Arm, REAR, Cake Feeder
10	1	See Chart	Dummy Arm, DRIVER Side

BED MODELS	STANDARD	BEEFCAKE 1000			BEEFCAKE 1500			BEEFCAKE 2000		
	Both Sides	Pass.	F	R	Pass.	F	R	Pass.	F	R
1870 Bev/Sqr	265071	NA	NA	NA	NA	NA	NA	NA	NA	NA
1871 Bev/Sqr	265132	NA	NA	NA	NA	NA	NA	NA	NA	NA
1876 Bev/Sqr	265005	265005	265186	266044	265005	265187	266045	NA	NA	NA
1879 Bev/Sqr	265133	265133	265186	266042	265133	265187	266046	265133	265187	266043
1976 Bev/Sqr	265006	265006	265186	266035	265006	265187	266036	NA	NA	NA
1984 Bev/Sqr	265007	265007	265186	266037	265007	265187	266038	265007	265187	266039
1988 Bev/Sqr	265162	NA	NA	NA	265162	265187	266040	265162	265187	266041

1800/1900 ELECTRICAL HARNESSES

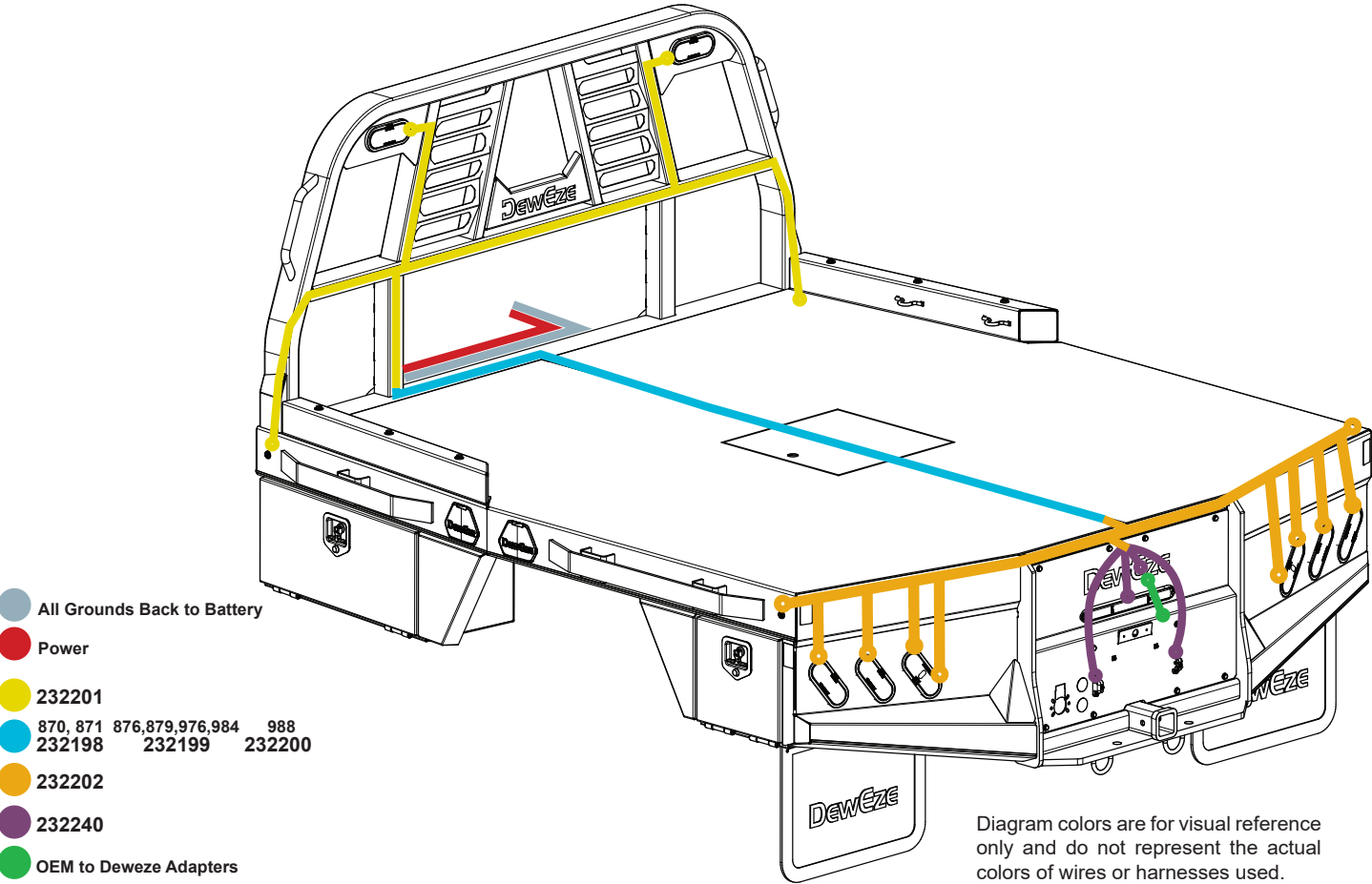

- All grounds must tie to the negative battery terminal. 800/900 series beds have a special grounded bolt near the driver’s side headache rack for easy grounding.
- Power is routed from the battery to switches in the cab, then one to clutch and one to valve.

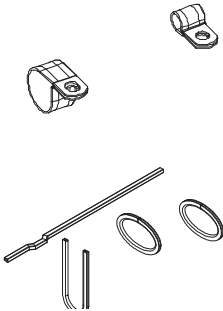

Adel clamps for securing harnesses	
102074	Clamp, Adel .75 x 1.25 x .406
110726	Clamp, Adel .75 x .5 x .406
112084	Edge Molding

● Headache Rack Harness

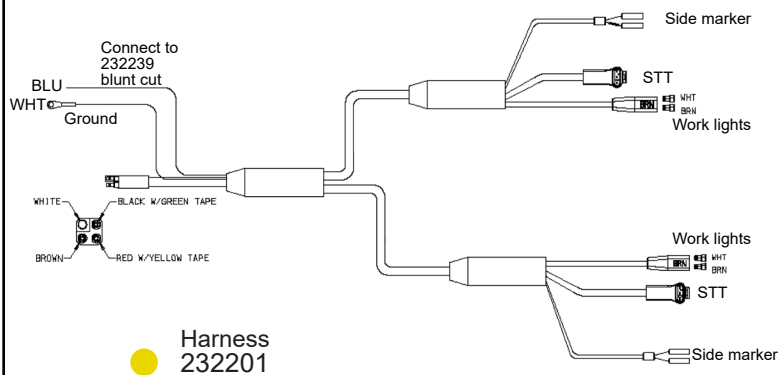

● Front to Rear Harness

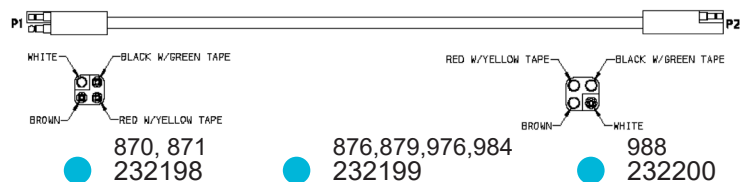

● Tailboard Harness

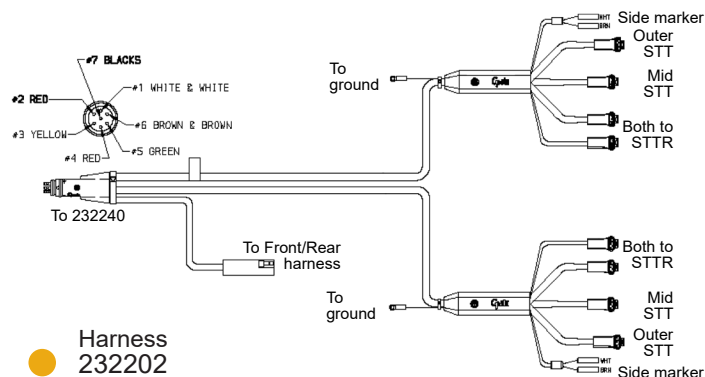

● Tailboard Harness Adapter

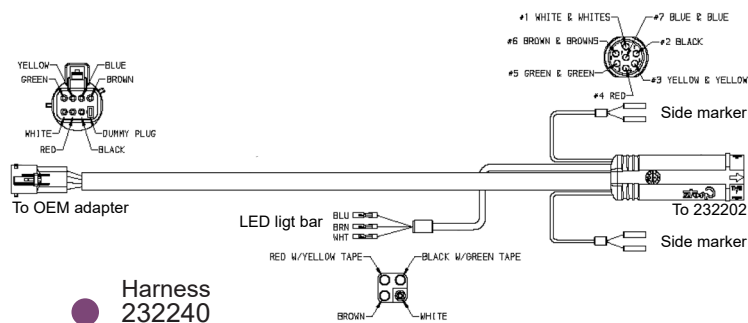

ITEM NO.		DESCRIPTION	YEAR
232234	FORD	Harness Adapter, <i>Box Delete</i>	2023+
232185		Harness Adapter, <i>Box Delete</i>	2020-2022
232177		Harness Adapter, <i>Box Delete</i>	2017-2019
232160		Harness Adapter, <i>Box Delete</i>	2011-2016
232176		Harness Adapter, <i>Box Delete</i>	2008-2010
232161		Harness Adapter, <i>Cab-chassis</i>	ALL
232192		Harness Adapter, Blis	2021+
232238	CHEVY	Harness Adapter, <i>Box Delete</i>	2024+
232178		Harness Adapter, <i>Box Delete</i>	2020-2023
232159		Harness Adapter, <i>Box Delete</i> & Cab-chassis	2016-2019
232158		Harness Adapter, <i>Box Delete</i> & Cab-chassis	2015
232187		Harness Adapter, <i>Cab-chassis</i>	2020+
232174		Harness Adapter, <i>Box Delete & Cab-chassis</i> , w 3rd Brake Light (cab)	2002-2014
232163		Harness Adapter, <i>Box Delete & Cab-chassis</i> , w/o 3rd Brake Light (cab)	2002-2014
232179		Harness Adapter, <i>MD DTY 4500-6500</i>	2019+
232193	DODGE	Harness Adapter, <i>Box Delete</i>	2019+
232233		Harness Adapter, <i>LED Box Delete</i>	2019+
232164		Harness Adapter, <i>Cab-chassis</i>	ALL
232162		Harness Adapter, <i>Generic</i>	ALL

DODGE

Deweze DOES NOT provide a solution for FAST FLASHING lights.
Customers can source LOAD EQUALIZERS independantly.

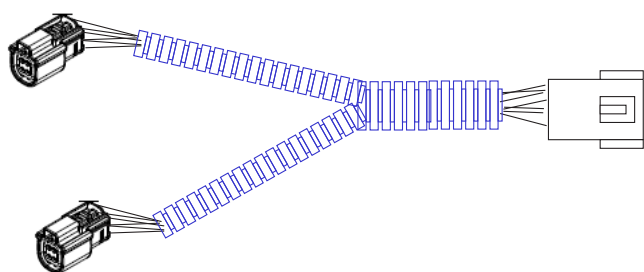

Harness
232193

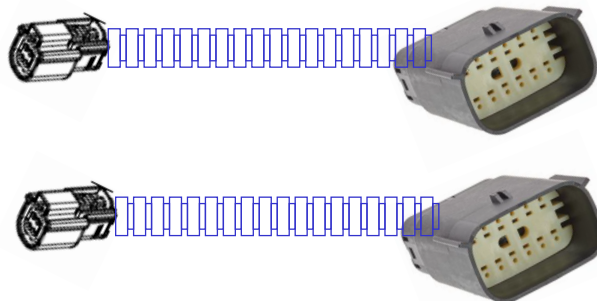

Harness
232233

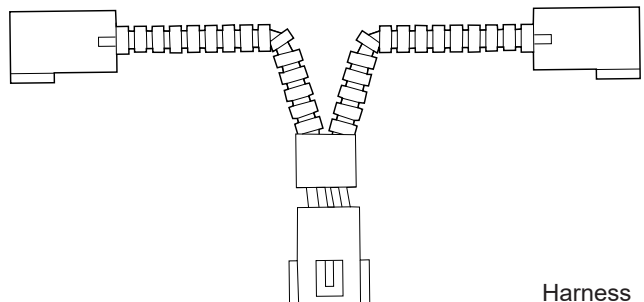

Harness
232164

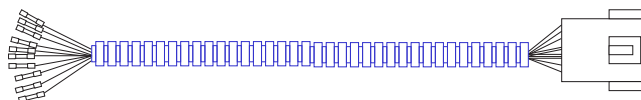

Harness
232162

FORD

● OEM to Deweze Adapters

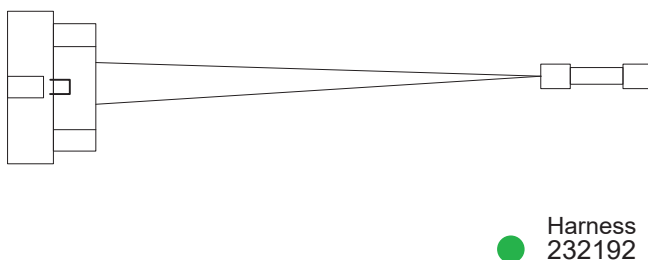
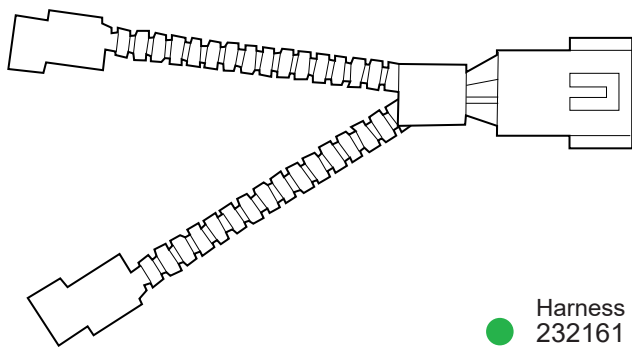
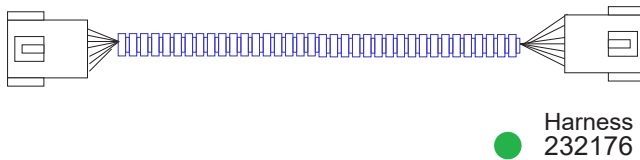
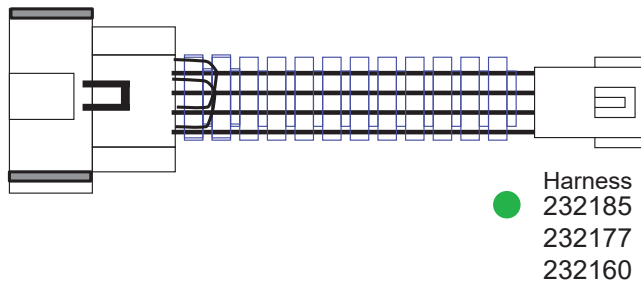
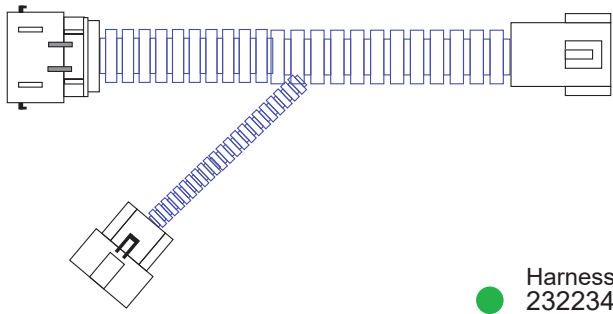

CHEVY

● OEM to Deweze Adapters

Purple wires only for fast flashing issue. See pg. 69

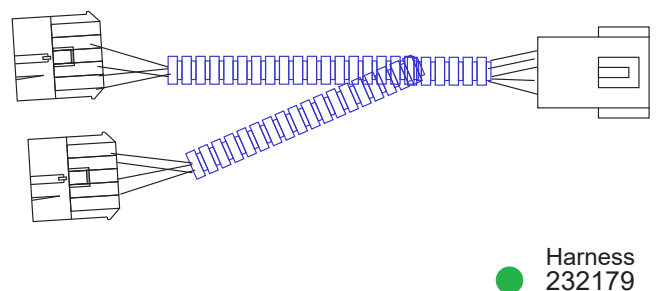
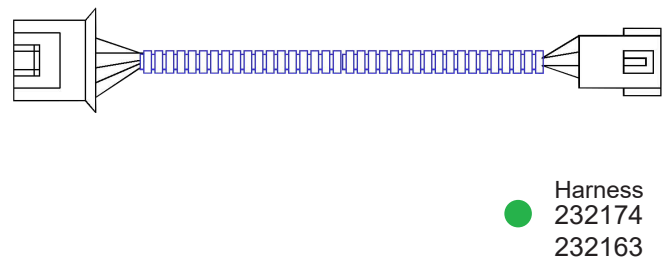
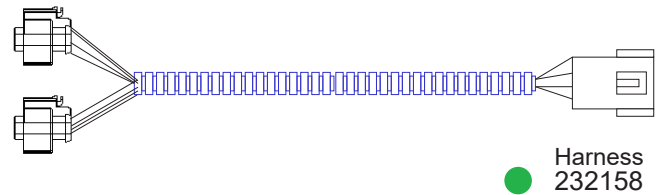
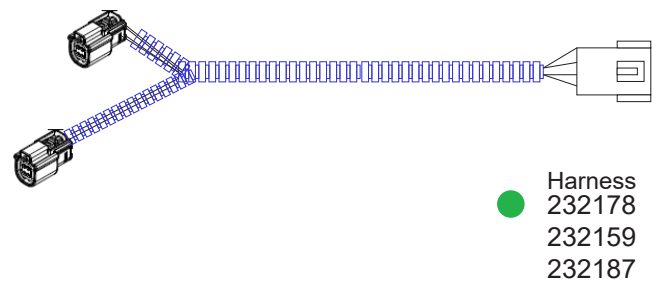
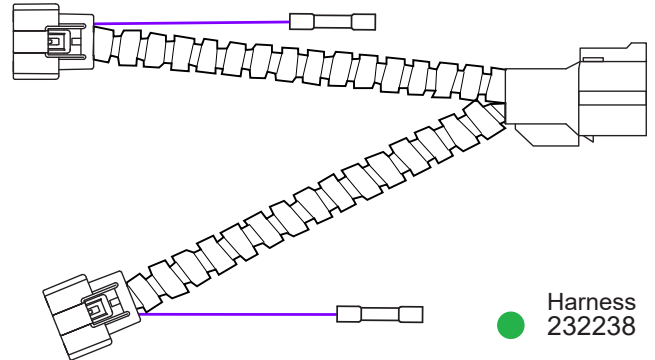

BED LIGHTS

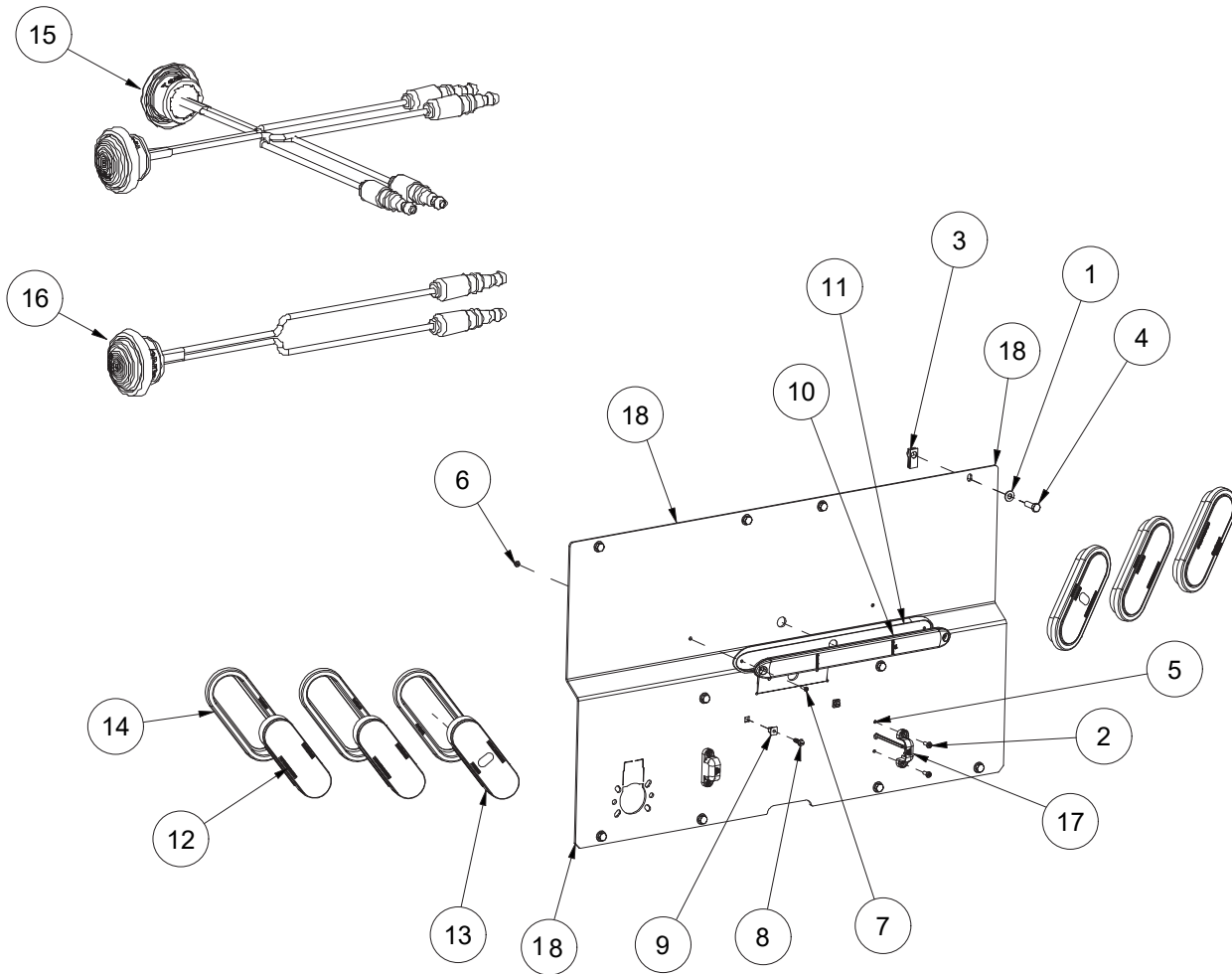

ITEM	QTY	PART #	DESCRIPTION
1	10	110069	Washer, 5/16" Flat Sae
2	4	110264	Bolt, 10-24 X .5 Stainless, Phillips
3	10	110319	Nut, 5/16-18 U-Type .75l
4	10	110423	Bolt, 5/16-18 X 1.0
5	4	110631	Nut, 10-24 Lock Nylon Insert
6	2	110633	Nut, #6/32 Machine Screw
7	2	110756	Screw, 6/32 X 1/2 In Pan Head
8	2	200050	Screw, #12 X 3/4 Hex Head
9	2	200051	Nylon License Plate Insert
10	1	232206	Light, Id And Load Lamp
11	1	232207	Trim Ring, Black
12	4	232209	Light, 6" Oval Stt
13	2	232210	Light, 6" Oval Sttr
14	6	232211	Grommet, 6" Oval
15	4	232212	Light, 3/4" Sidemarker, Amber
16	2	232213	Light, 3/4" Sidemarker, Red
17	2	232242	Light, License, Vertical Mount, Short
18	1	261346	Panel, Flatbbbed Tailboard

HEADACHE RACK LIGHTS

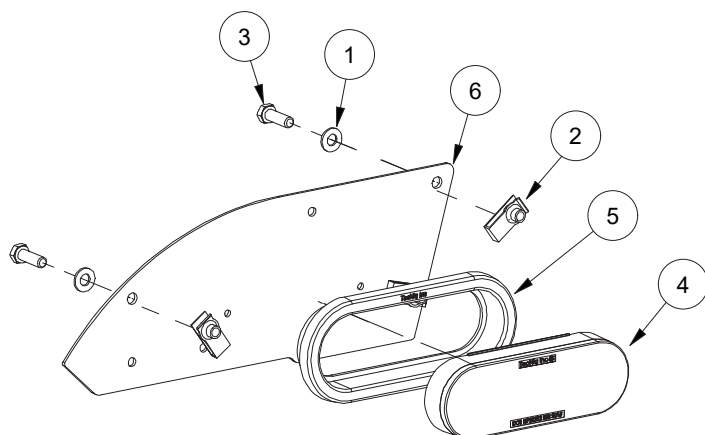

Parts List

ITEM	QTY	PART #	DESCRIPTION
1	6	110069	WASHER, 5/16" FLAT SAE
2	6	110319	NUT, 5/16-18 U-TYPE .75L
3	6	110423	BOLT, 5/16-18 X 1.0
4	2	232209	LIGHT, 6" OVAL STT
5	2	232211	GROMMET, 6" OVAL
6	2	261156	COVER, LIGHT

HEADACHE RACK SWING LIGHT KIT

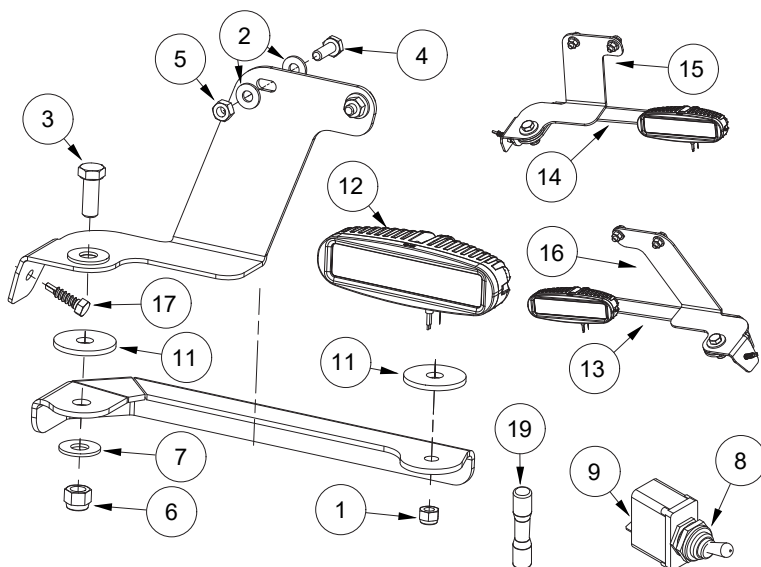

Parts List

Kit: 264043

ITEM	QTY	PART #	DESCRIPTION
1	2	110230	Nut, M8 X 1.25, Lock Nylon
2	8	110298	Washer, 1/4" Flat Sae
3	2	110420	Bolt, 3/8-16 X 1.0
4	4	110561	Bolt, 1/4-20 X .75
5	4	110609	Nut, 1/4-20
6	2	110618	Nut, 3/8-16 Lock Nylon Insert
7	4	110676	Washer, 3/8" Flat Standard
8	1	132035	Switch Boot
9	1	132135	Switch, Toggle, Spst, On-Off
10	1	132147	Terminal, Butt Connect 16-14, Heat Shink
11	4	211747	Friction Washer 1.5"
12	2	232243	LED, 5" Rect, Flood, Bullet Connectors
13	1	260624	Bracket, Swing Light, Arm, Right
14	1	260625	Bracket, Swing Light, Arm, Left
15	1	261206	Bracket, Swing Light, Left
16	1	261207	Bracket, Swing Light, Right
17	2	710586	Screw, 1/4 X 1 Tek Self-Tap

232214
NOT USED

HEADACHE RACK FIXED LIGHT KIT

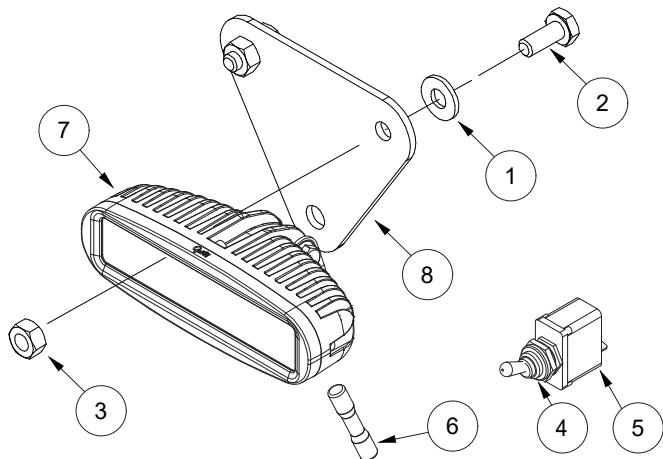

Parts List

Kit: 264034

ITEM	QTY	PART #	DESCRIPTION
1	4	110298	Washer, 1/4" Flat SAE
2	4	110299	Bolt, 1/4-20 X .625 Hex GR 5
3	4	110609	Nut, 1/4-20
4	1	132035	Switch Boot
5	1	132135	Switch, Toggle, SPST, On-Off
6	2	132147	Terminal, Butt Connect 16-14, Heat Shink
7	2	232243	LED, 5" Rect, Flood, Bullet Connectors
8	2	260626	Bracket, Cargo Light

232214
NOT USED

264132

REV:

HEADACHE RACK COVERS (REGULAR)

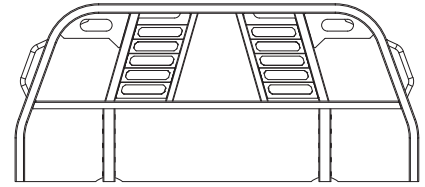
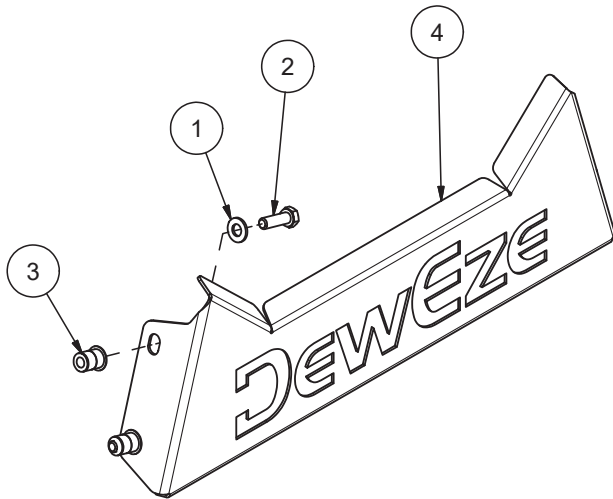

Parts List

ITEM	QTY	PART #	DESCRIPTION
1	4	110069	Washer, 5/16" Flat Sae
2	4	110423	Bolt, 5/16-18 X 1.0
3	4	110849	Nut, 5/16-18 Rivet Steel
4	1	261105	Plate, Deweze

264132

REV:

HEADACHE RACK COVERS (MEDIUM)

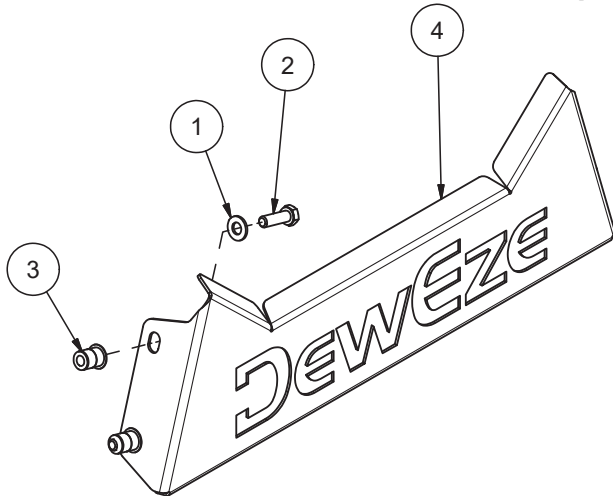

Same as regular

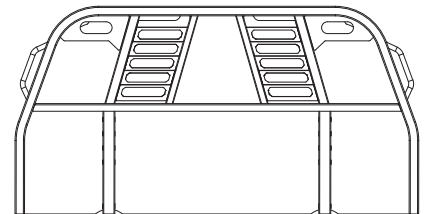

Parts List

ITEM	QTY	PART #	DESCRIPTION
1	4	110069	Washer, 5/16" Flat Sae
2	4	110423	Bolt, 5/16-18 X 1.0
3	4	110849	Nut, 5/16-18 Rivet Steel
4	1	261105	Plate, Deweze

264133

REV:

HEADACHE RACK COVERS (TALL)

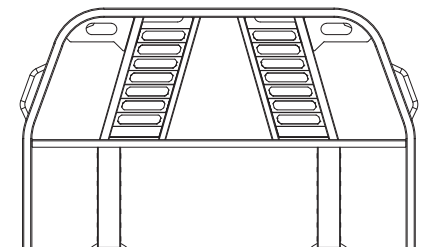
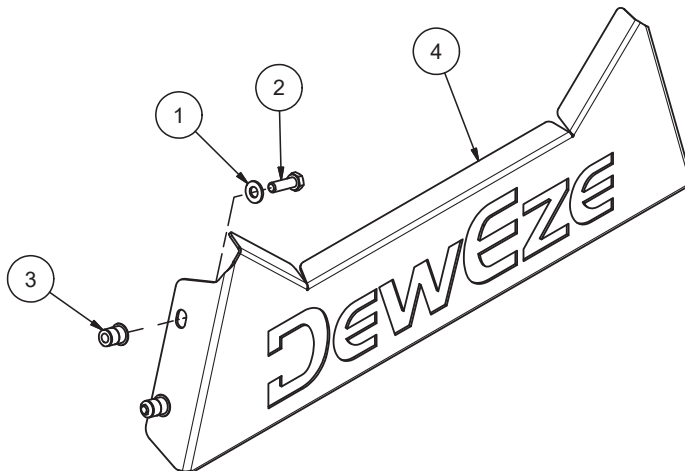

Parts List

ITEM	QTY	PART #	DESCRIPTION
1	4	110069	Washer, 5/16" Flat Sae
2	4	110423	Bolt, 5/16-18 X 1.0
3	4	110849	Nut, 5/16-18 Rivet Steel
4	1	261319	Plate, Deweze, Tall

STANDARD BALL WELL ASSEMBLY

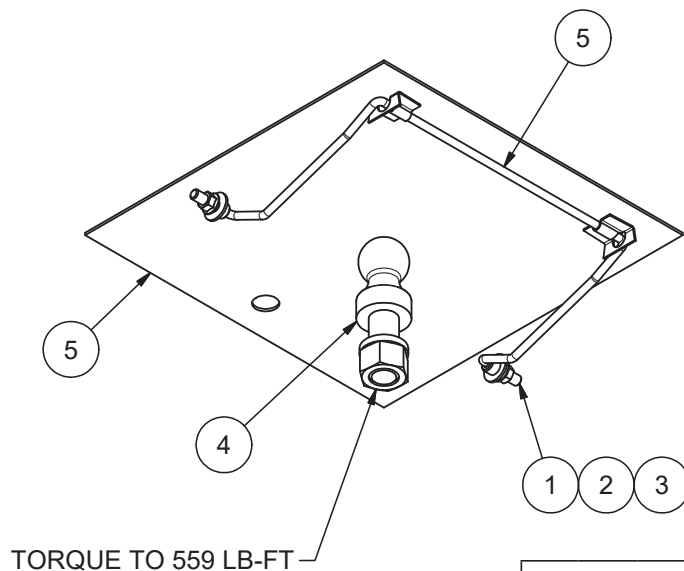

Parts List

ITEM	QTY	PART #	DESCRIPTION
1	2	110244	Bolt, 1/2-1 3 X 1.5 Shcs
2	2	110588	Nut, 1/2-1 3 W/iz Flange
3	2	110658	Washer, 1/2" Flat Standard
4	1	212032	Hitch Ball, 2 5/16 X 1 3/8 X 1 With Hardware
5	1	265172	Weldment, Ball Well Door

RECEIVER HITCH ADAPTER KIT

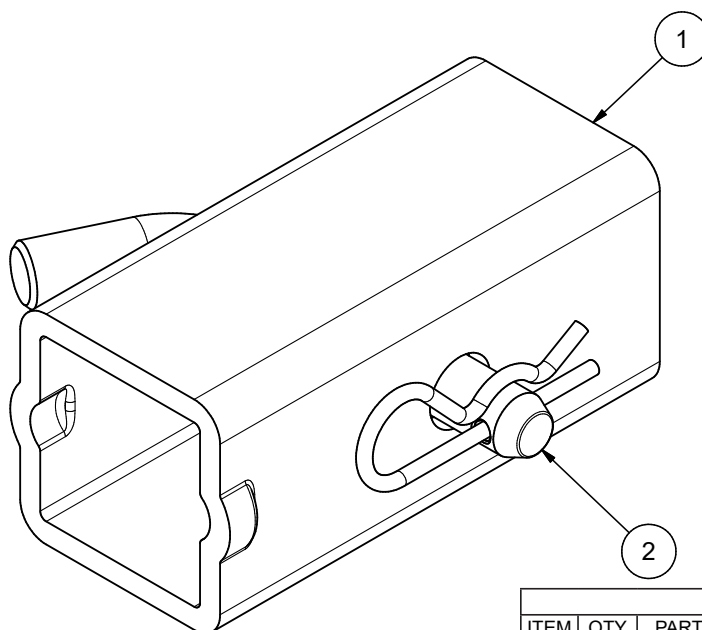

Parts List

ITEM	QTY	PART #	DESCRIPTION
1	1	262004	Adapter Sleeve, 2.5" To 2"
2	1	263006	Hitch Pin Assembly, 5/8"

SKIRT SELECTION DETAILS

BED MODELS	FRONT (w/TBX)	REAR (w/TBX)		REAR (no/TBX)	
	ALL BEDS	BEVELLED	SQUARE	BEVELLED	SQUARE
1870	264049	264049	264062	264047	264053
1871	264049	264049	264062	264047	264053
1876	264062	264049	264062	264047	264053
1879	264062	264062	264062	264053	264054
1976	264062	264049	264062	264047	264053
1984	264062	264062	264062	264053	264054
1988	264088	264062	264062	264053	264054
1988 x2 30" TBX	264049	264062	264062	264053	264054

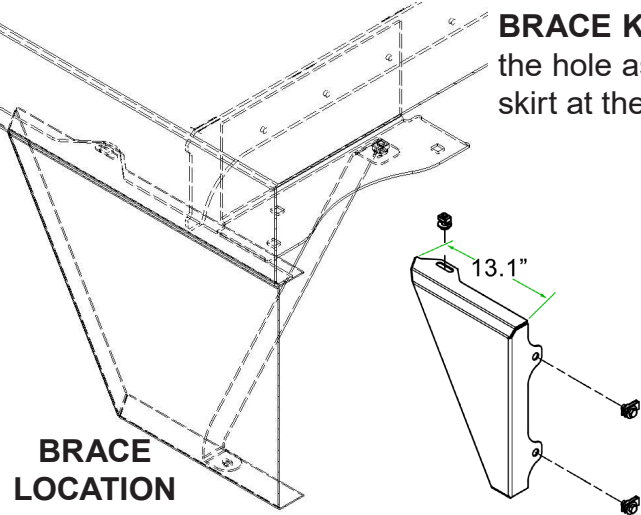

BRACE KITS have been added to shore up rear skirts. Utilize the hole as shown in the image to the left and drill a hole in the skirt at the appropriate place for your alignment.

264062 PARTS LIST			
Item	Qty	Part #	DESCRIPTION
1	1	261117	F DRV, 13.1"
2	1	261118	F PSS, 13.1"
3	1	264048	KIT, FILLER SKIRT HARDWARE

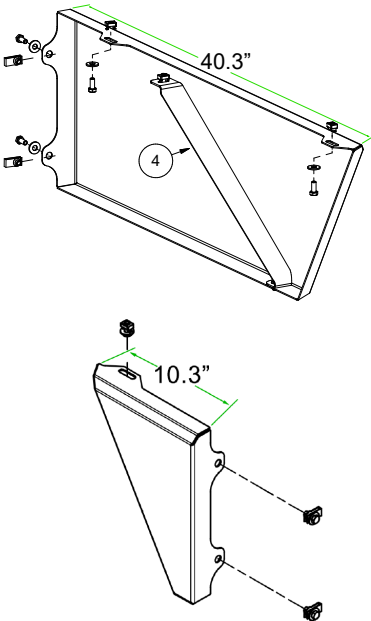

264088 PARTS LIST				A
Item	Qty	Part #	DESCRIPTION	
1	1	261294	F DRV, 40.3"	
2	1	261295	F PSS, 40.3"	
3	1	264105	KIT, FILLER SKIRT HARDWARE	
4	1	264135	KIT, SKIRT BRACES	

264049 PARTS LIST				A
Item	Qty	Part #	DESCRIPTION	
1	1	261115	F DRV or R PSS, 10.3"	
2	1	261116	R DRV or F PSS, 10.3"	
3	1	264048	KIT, FILLER SKIRT HARDWARE	

264047 PARTS LIST B			
Item	Qty	Part #	DESCRIPTION
1	1	261123	R DRV, 24.8"
2	1	261124	R PSS, 24.8"
3	1	264048	KIT, FILLER SKIRT HARDWARE
4	1	264135	KIT, SKIRT BRACES

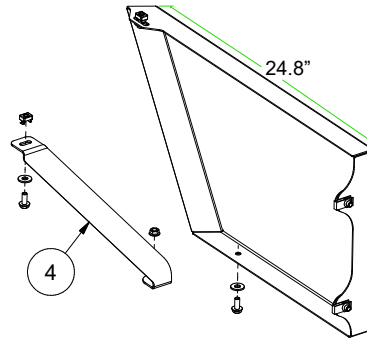

264053 PARTS LIST A			
Item	Qty	Part #	DESCRIPTION
1	1	261132	R DRV, 31.8"
2	1	261133	R PSS, 31.8"
3	1	264048	KIT, FILLER SKIRT HARDWARE
4	1	264135	KIT, SKIRT BRACES

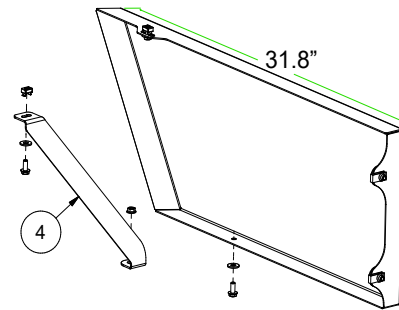

264054 PARTS LIST A			
Item	Qty	Part #	DESCRIPTION
1	1	261184	R DRV, 38.9"
2	1	261185	R PSS, 38.9"
3	1	264048	KIT, FILLER SKIRT HARDWARE
4	1	264135	KIT, SKIRT BRACES

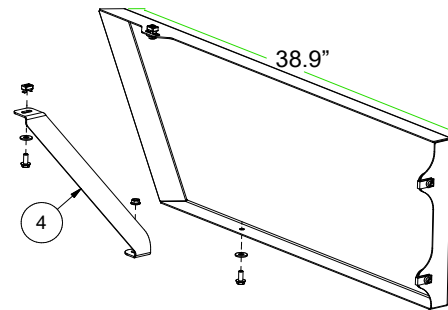

264051 (newest models use 264062) A			
Item	Qty	Part #	DESCRIPTION
1	1	261119	R PSS, 13.8"
2	1	261120	R DRV, 13.8"
3	1	264048	KIT, FILLER SKIRT HARDWARE

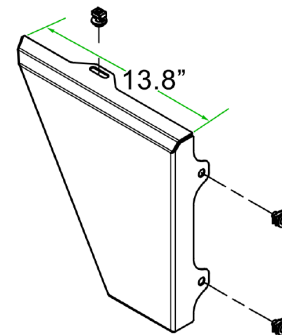

264055 (newest models use 264062) A			
Item	Qty	Part #	DESCRIPTION
1	1	261121	F DRV, 15.6"
2	1	261122	F PSS, 15.6"
3	1	264048	KIT, FILLER SKIRT HARDWARE

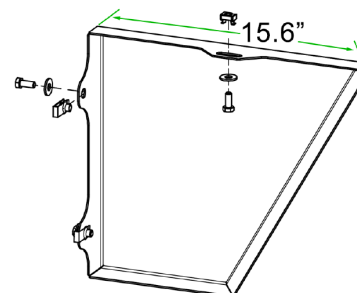

TOOLBOX SELECTION DETAILS

BED MODELS	FRONT TOOLBOX	REAR TOOLBOX	
	ALL BEDS	BEVELLED	SQUARE
1870	14.5"	14.5"	18"
1871	18"	14.5"	18"
1876	30"	14.5"	18"
1879	30"	18"	24"
1976	30"	14.5"	18"
1984	30"	18"	24"
1988	30"	18"	24"

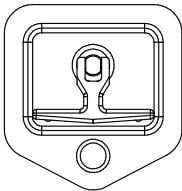
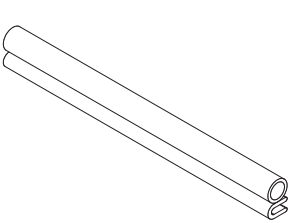

PART #	DESCRIPTION
102030	Toolbox Seal (sold by foot)
102053	Plug, Button 1.00
282011	Toolbox Latch

263001
30"

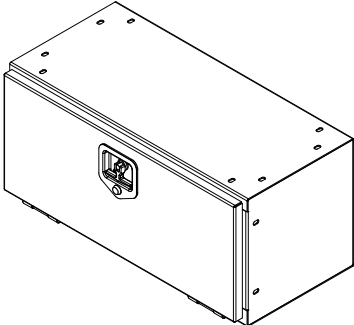

30 x 14 x 13.5"

263003
14.5"

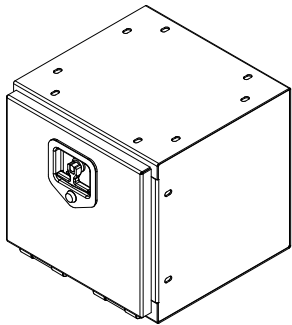

14.5 x 14 x 13.5"

263002
24"

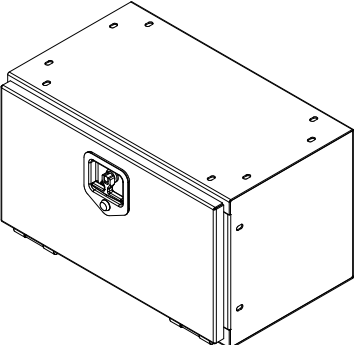

24 x 14 x 13.5"

263004
18"

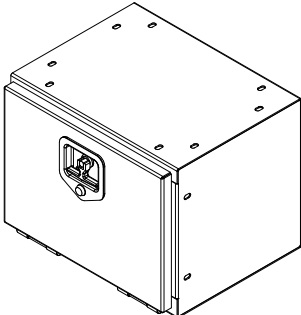

18 x 14 x 13.5"

210915

79 x 21.5 x 17.6"

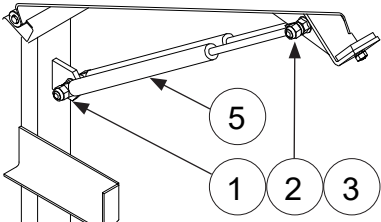
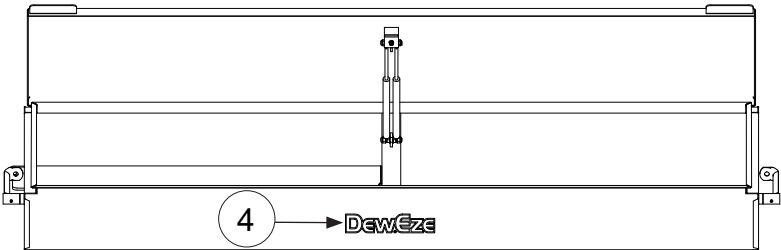
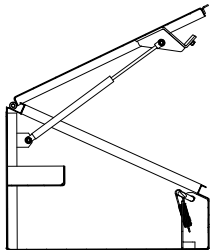

210915 PARTS LIST				
ITEM	QTY	PART #	DESCRIPTION	
1	4	110618	NUT, 2/8-16 LOCK NYLON INSERT	
2	4	110645	NUT, 3/8-16 WIZ FLANGE	
3	2	210908	SHOCK MOUNT BOLT	
4	1	400010	DECAL, DEWEZE BLACK OUTLINE	
5	2	500078	SHOCK, GAS FILLED	

FRONT TOOLBOX INSTALL KIT

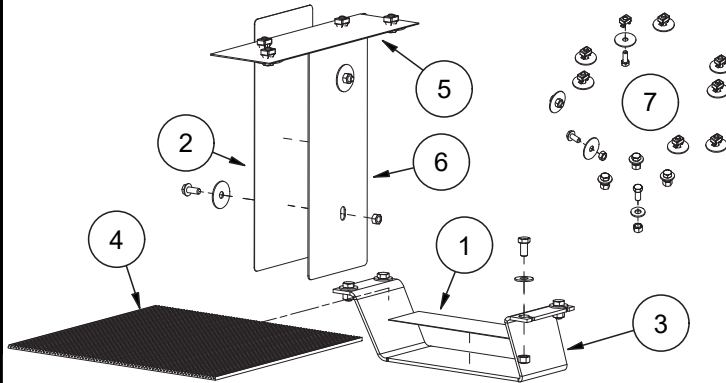

Parts List Kit: 264044			
ITEM	QTY	PART #	DESCRIPTION
1	2	100449	Traction Pad, Flex-Tread 2.75" X 0.75'
2	2	202169	Decal, Chip Guard
3	2	211109	Step, Toolbox
4	2	211119	Tool Box Mat
5	4	212003	Gasket, Toolbox Mount
6	2	261014	Plate, Chip Guard
7	1	264045	Kit, Toolbox Hardware, Front

REAR TOOLBOX INSTALL KIT

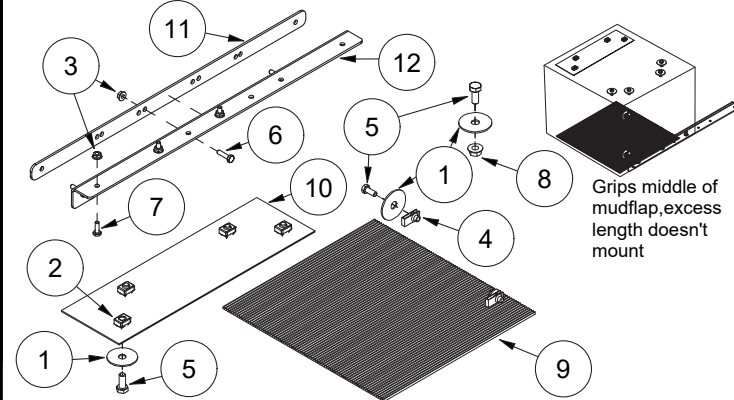

Parts List Kit: 264050			
ITEM	QTY	PART #	DESCRIPTION
1	20	110049	Washer, 5/16" X 1 1/2 Fender
2	8	110258	Nut, 5/16-18, Cage Tinnerman
3	12	110290	Nut, 1/4-20 WIZ Flange
4	4	110319	Nut, 5/16-18 U-Type .75I
5	20	110444	Bolt, 5/16-18 X .75 WIZ Flange
6	6	110464	Bolt, 1/4-20 X 1.0
7	6	110561	Bolt, 1/4-20 X .75
8	8	110606	Nut, 5/16-18 WIZ Flange
9	2	211119	Tool Box Mat
10	2	212003	Gasket, Toolbox Mount
11	2	261011	Backer Plate, Long
12	2	261203	Bracket, Mudflap, Wide

MUDFLAP, WIDE 24X36"

Mudflaps still mount to stringer
(above toolbox)

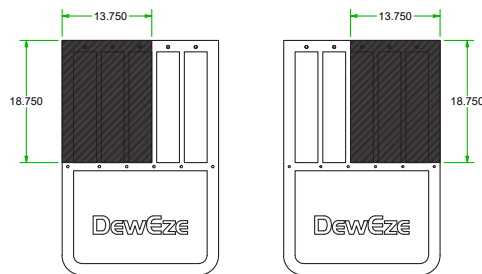

Cut and remove shaded areas for rear toolboxes

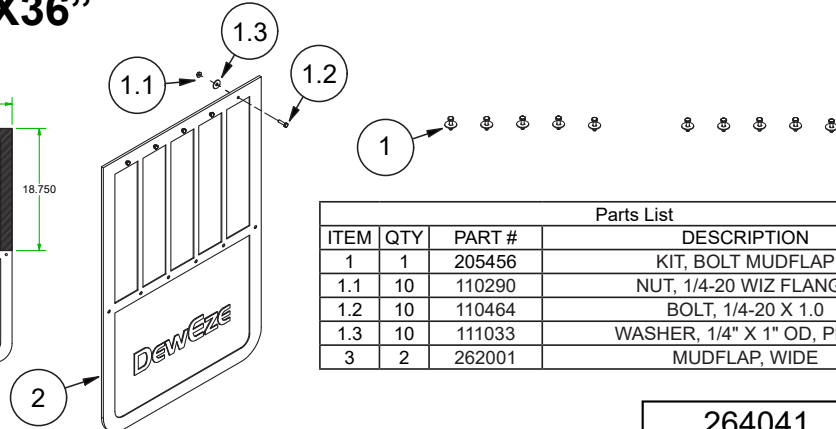

Parts List			
ITEM	QTY	PART #	DESCRIPTION
1	1	205456	KIT, BOLT MUDFLAP
1.1	10	110290	NUT, 1/4-20 WIZ FLANGE
1.2	10	110464	BOLT, 1/4-20 X 1.0
1.3	10	111033	WASHER, 1/4" X 1" OD, PLAIN
3	2	262001	MUDFLAP, WIDE

MUDFLAP, NARROW 20X36"

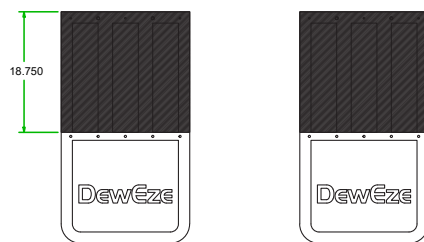

Cut and remove shaded areas for rear toolboxes

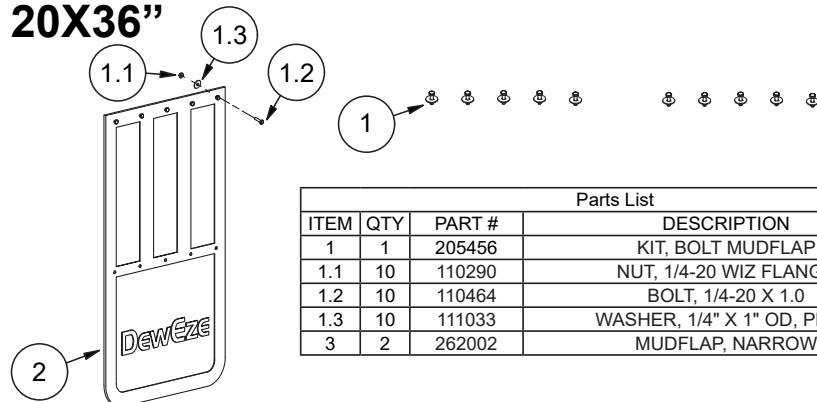

Parts List			
ITEM	QTY	PART #	DESCRIPTION
1	1	205456	KIT, BOLT MUDFLAP
1.1	10	110290	NUT, 1/4-20 WIZ FLANGE
1.2	10	110464	BOLT, 1/4-20 X 1.0
1.3	10	111033	WASHER, 1/4" X 1" OD, PLAIN
3	2	262002	MUDFLAP, NARROW

REAR VIEW CAMERA MOUNTING KITS *

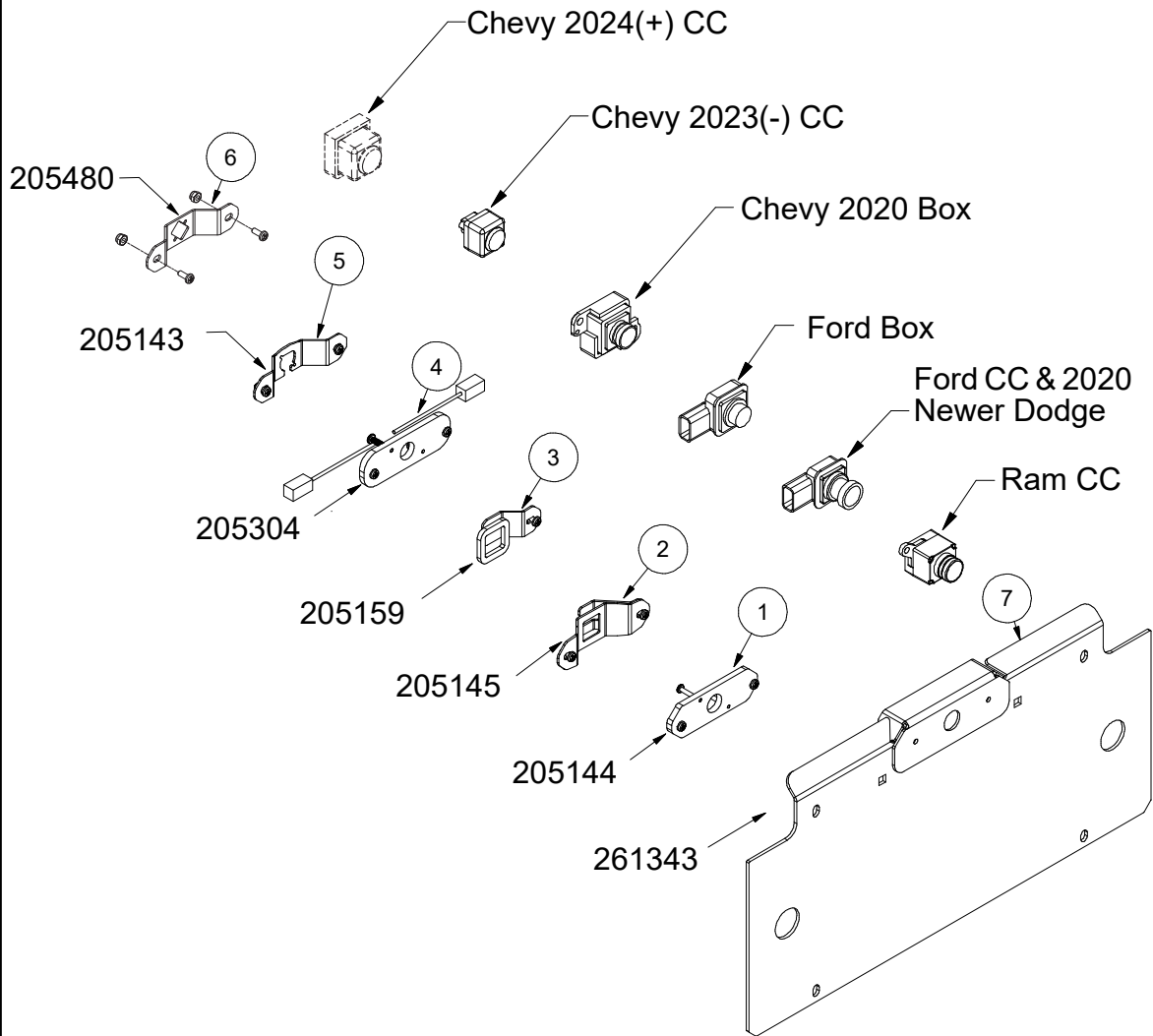

***Mount Disclaimer:** These mounting kits were designed for the most common mounting-to-camera. Manufacturers change camera styles & mountings even within the same year. Use best practices to modify if need be.

***Installer note:** DewEze does not engineer wiring nor harnesses for the camera. It is the installers' responsibility to trace the OEM cable to re-attach.

Item	Qty	Part #	DESCRIPTION
1	1	205144	Dodge/Ram CC Camera Mount Kit
2	1	205145	Ford Camera & Dodge 2020+ Mount Kit
3	1	205159	Ford Box Take-Off Camera Mount Kit
4	1	205304	Chevy/ GM 2020 Box Take-Off Camera Mount Kit
5	1	205143	Chevy/GM CC 2023- Camera Mount Kit
6	1	205480	Chevy/GM CC 2024+ Camera Mount Kit
7	1	261343	Camera Mount Weldment

BED MOUNTING KITS

NOTE: Red highlighted kits have not been engineered. Examples of these trucks have not been made available to the factory engineers.

MAKE	PART #	YEAR	DESCRIPTION
FORD	205435	2017+	Ford BTO 871, 876, 976
	205441	1996-2016	Ford BTO 871
	205432	1999-2016	Ford BTO 876, 976
	205459	2017+	Ford Cab-Chassis 879, 984
	205460	1999-2016	Ford Cab-Chassis 879, 984
	205461	2017+	Ford Cab-Chassis 988
	205462	1999-2016	Ford Cab-Chassis 988
CHEVY GMC	205453	2020+	Chevy BTO 871
	205451	2011-2019	Chevy BTO 871
	205468	2000-2010	Chevy BTO 871
	205452	2020+	Chevy BTO 876, 976
	205440	2011-2019	Chevy BTO 876, 976
	205442	2000-2010	Chevy BTO 876, 976
	205458	2011+	Chevy Cab-Chassis 984
	205465	2000-2010	Chevy Cab-Chassis 984
	205463	2011+	Chevy Cab-Chassis 988
	205466	2019+	Chevy Cab-Chassis 984 (4500-5500)
	205467	2019+	Chevy Cab-Chassis 988 (4500-5500)
DODGE RAM	205434	2019+	Dodge BTO 870
	205437	2014-2018	Dodge BTO 870
	205469	2003-2013	Dodge BTO 870
	205439	2003-2013	Dodge BTO 876, 976
	205433	2019+	Dodge (3500) BTO 876, 976
	205436	2014+	Dodge (2500) BTO 876, 976
	205438	2014-2018	Dodge (3500) BTO 876, 976
	205455	2007+	Dodge Cab-Chassis 879, 984
	205457	2007+	Dodge Cab-Chassis 988
Misc.	205029		Yellow Bag & Contents (<i>applicable to older truck models not listed above</i>)

BED STRINGER MEASUREMENTS

STRINGERS FOR: _79, _84, _88

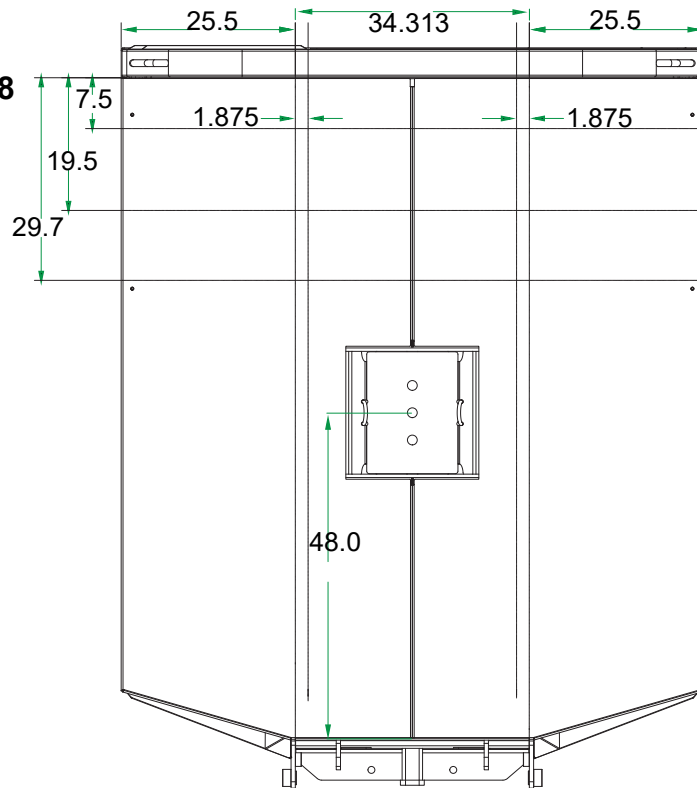

STRINGERS FOR: _76

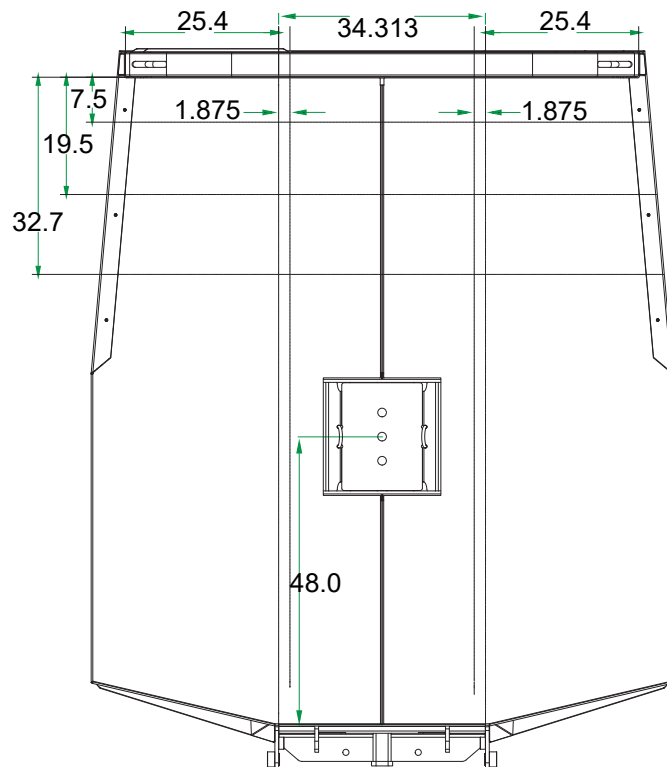

NOTES

Harper Industries, Inc.
151 E. Highway 160
Harper, KS 67058

Telephone: 620-896-7381
Toll-Free: 800-835-1042
Fax: 620-896-7129

Website: www.harperindustries.com

E-mail: info@harperindustries.com